

**Polymer
PTC Devices**

Strap resettable fuses

Shanghai Wayon Thermo/Electro Materials Co.,Ltd.

4th Floor, No.201, New Jinqiao Road, Shanghai 201206,China

Tel: 86-21- 50320161 58995165

Fax: 86-21-50320266

E-mail: market@way-on.com

[Http://www.way-on.com](http://www.way-on.com)



LP560

Features

- Strap devices, Axial leaded, Low initial resistance
- Designed to use for battery packs protection
- Agency Recognition: UL、CSA、TUV



Product Dimensions (mm)

Part number	A		B		C		D ₁		D ₂		E	
	Min	Max	Min	Max	Min	Min	Min	Max	Min	Max	Min	Max
LP560	24.0	26.0	13.4	14.0	0.5	24.0	24.0	6.9	5.0	6.1	24.0	26.0

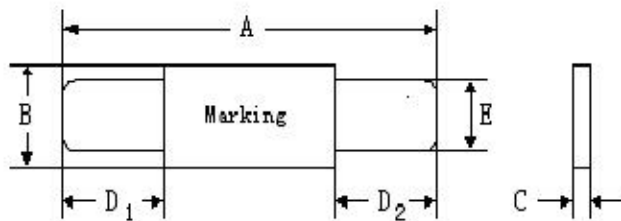

Marking system

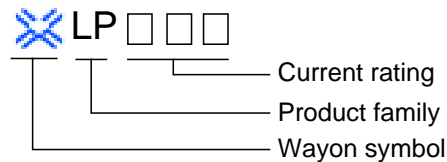

* Lead materials: Nickel.

* Insulating material: Polyester tape.

Electrical Characteristics

Part number	I_H	I_T	T_{trip}		V_{max}	I_{max}	R_{min}	R_{max}
	(A)	(A)	Current(A)	Time(S)	(V)	(A)	()	()
LP560	5.60	10.80	30	5.0	20	100	0.009	0.016

I_H =Hold current: maximum current at which the device will not trip at 25 still air.

I_T =Trip current: minimum current at which the device will always trip at 25 still air.

T_{trip} =Maximum time to trip(s) at assigned current.

V_{max} =Maximum voltage device can withstand without damage at rated current.

I_{max} =Maximum fault current device can withstand without damage at rated voltage.

R_{min} =Minimum device resistance at 25 prior to tripping.

R_{max} =Maximum device resistance at 25 prior to tripping.

Package Information

Bulk: 500pcs per bag.