

**Polymer  
 PTC Devices**

*Strap resettable fuses*

**Shanghai Wayon Thermo/Electro Materials Co.,Ltd.**  
 4th Floor, No.201, New Jinqiao Road, Shanghai 201206,China  
 Tel: 86-21- 50320161 58995165 Fax: 86-21-50320266  
 E-mail: [market@way-on.com](mailto:market@way-on.com) [Http://www.way-on.com](http://www.way-on.com)



**LP600**

**Features**

- Strap devices, Axial leaded, Low initial resistance
- Designed to use for battery packs protection
- Agency Recognition: UL、CSA、TUV



**Product Dimensions (mm)**

Part number	A		B		C		D		E	
	Min	Max	Min	Max	Min	Max	Min	Max	Min	Max
LP600	24.0	26.0	13.4	14.0	0.5	1.0	5.0	6.9	5.0	6.1

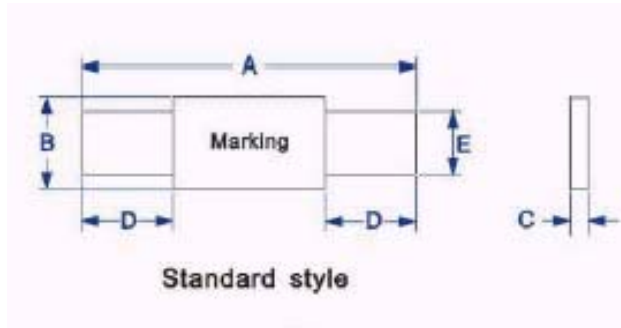

**Marking system**

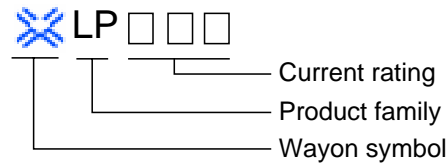

\* Lead materials: Nickel.

\* Insulating material: Polyester tape.

**Electrical Characteristics**

Part number	$I_H$ (A)	$I_T$ (A)	$T_{trip}$ Current(A) Time(S)	$V_{max}$ (V)	$I_{max}$ (A)	$R_{min}$ ( )	$R_{max}$ ( )
LP600	6.00	11.70	30 5.0	20	100	0.007	0.014

$I_H$ =Hold current: maximum current at which the device will not trip at 25 still air.

$I_T$ =Trip current: minimum current at which the device will always trip at 25 still air.

$T_{trip}$ =Maximum time to trip(s) at assigned current.

$V_{max}$ =Maximum voltage device can withstand without damage at rated current.

$I_{max}$ =Maximum fault current device can withstand without damage at rated voltage.

$R_{min}$ =Minimum device resistance at 25 prior to tripping.

$R_{max}$ =Maximum device resistance at 25 prior to tripping.

**Package Information**

Bulk: 500pcs per bag.