

LP900

Features

- Strap devices, Axial leaded, Low initial resistance
- Designed to use for battery packs protection
- Agency Recognition: UL、CSA、TUV



Product Dimensions (mm)

Part number	A		B		C		D		E	
	Min	Max	Min	Max	Min	Max	Min	Max	Min	Max
LP900	45.0	48.0	7.9	8.5	0.5	1.3	4.0	7.0	5.9	6.1

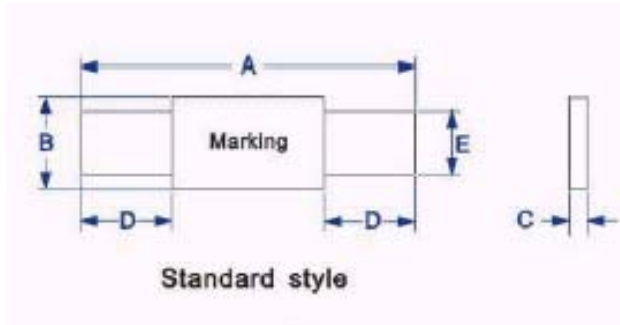

Marking system

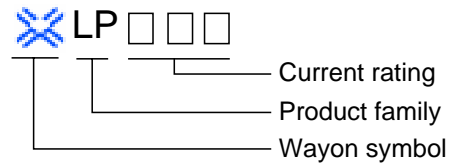

* Lead materials: Nickel.

* Insulating material: Polyester tape.

Electrical Characteristics

Part number	I_H	I_T	T_{trip}		V_{max}	I_{max}	R_{min}	R_{max}
	(A)	(A)	Current(A)	Time(S)	(V)	(A)	()	()
LP900	9.00	16.70	45.0	5.0	20	100	0.006	0.010

I_H =Hold current: maximum current at which the device will not trip at 25 still air.

I_T =Trip current: minimum current at which the device will always trip at 25 still air.

T_{trip} =Maximum time to trip(s) at assigned current.

V_{max} =Maximum voltage device can withstand without damage at rated current.

I_{max} =Maximum fault current device can withstand without damage at rated voltage.

R_{min} =Minimum device resistance at 25 prior to tripping.

R_{max} =Maximum device resistance at 25 prior to tripping.

Thermal Derating Chart- I_H (A)

Part number	Maximum ambient operating temperatures()								
	-40	-20	0	25	40	50	60	70	85
LP900	13.10	11.80	10.40	9.00	7.60	6.90	6.30	5.60	4.60

Package Information

Bulk: 1000pcs per bag.